



A unique product of American ingenuity—This timeless toy delights another generation!

How's It Go?

1. Sit on the middle of the seat.
2. Place feet on the handlebars.
3. Grip the handlebars.
4. Swing the handlebars from side to side (don't just turn them—**swing!!**)



The Flying Turtle® has a One Year Limited Warranty. This product is designed for home-use only. Usage in institutional or commercial settings voids warranty. Replacement parts are available. Contact Big Time Toys to order. As per our discretion, we will replace the defective part or the entire unit. This warranty does not cover damages resulting from misuse of product.

Safety Instructions

The **Flying Turtle**® is a safe toy for children following these guidelines.

1. Do not use on or near inclines, roadways, bodies of water or stairs.
2. Always ride seated with feet on the handlebars.
3. Wear shoes and a helmet.
4. Allow only one rider at a time.
5. Weight limit is 150 lbs.



Big Time Toys, LLC.
2823 Dogwood Place, Nashville, TN 37204
Toll Free 800-419-3810
www.bigtimetoys.com



We are happy that you are happy. If you don't know how to express your happiness, we've got a few recommendations...



Share your happy experience with an online review.



Not Happy?

Our friendly supportive service will work hard to put a smile back on your face. Here's how we can connect:



Email us at:
info@bigtimetoys.com



Easy Assembly Instructions

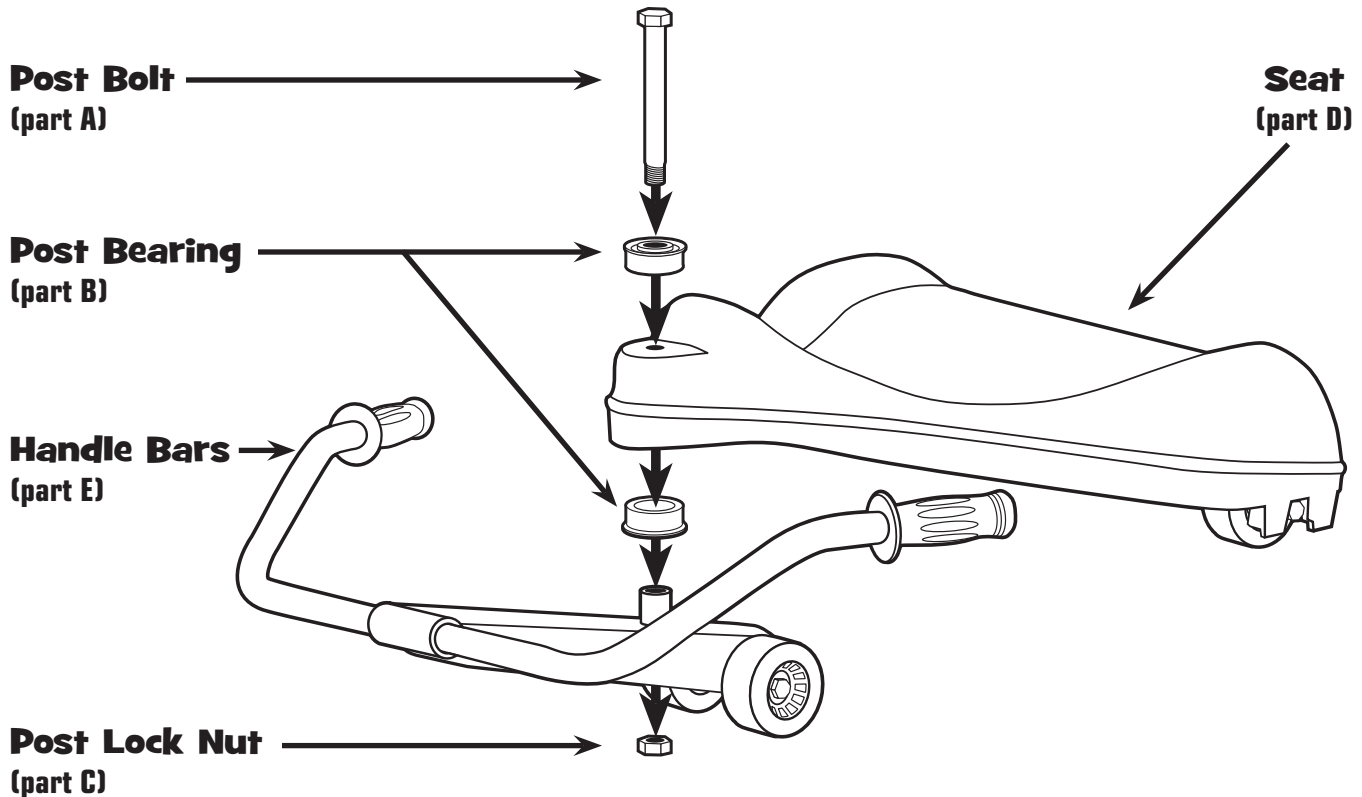

Thank you for your recent purchase of the original Flying Turtle®. Within just a few moments and in four easy steps, you will have your Flying Turtle® completely assembled and ready for hours of fun in the years to come.

Tools Needed

2 – ¾" Socket Wrenches - Included

Step One

Remove the ¾" Post Lock Nut (**part C**) from the Post Bolt that extends through the hole in the Flying Turtle Seat (**part D**).

Step Two

Gently tap the Post Bearings (**part B**), both top and bottom, with a hammer or mallet, so that they fit snugly in the front of the seat (**part D**).

Step Three

Slide the Flying Turtle handlebars (**part E**) over the Post Bolt (**part A**) that has been inserted through the top of the Flying Turtle seat (**part D**) (See Diagram).

Step Four

Attach the Post Lock Nut (**part C**) to the Post Lock Bolt. Place one ¾" socket or box end wrench on the Post Bolt (**part A**) and the other ¾" socket/box end wrench on the Post Lock Nut (**part C**). Tighten. NOTE: The seat should move freely, with only a slight amount of tension when you hold the handlebars and swing the seat from side to side.

Your Flying Turtle® is now ready for hours of fun!